

1 2 3 4

A



B

# EXTERNAL MAINTENANCE BYPASS

## 20kW, 3-SWITCHES

C

Product number: P-105000044-003

D

E

METRIC

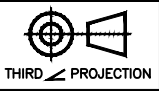

# EATON CORPORATION



DIMENSIONS ARE IN MILLIMETERS AFTER PLATING, DIMENSIONS AND TOLERANCES IN ACCORDANCE WITH ASME Y14.5M-1994. SEE NOTES FOR TOLERANCES.

DESCRIPTION: EXTERNAL MBS 20kW, 3-SWITCHES

|                          |            |                 |                 |           |              |
|--------------------------|------------|-----------------|-----------------|-----------|--------------|
| ORIGINATED: E5900083 /JP | 15.05.2015 | ECO:            | NAME:           | REVISION: | SIZE: A4     |
| MODIFIED: E9917864/EY    | 18.09.2015 | ECD-089242      | P-105000044-003 | 002       | NOT TO SCALE |
| CHECKED: E5900525/TMK    |            | DOCUMENT TYPE:  |                 | STATE:    | SHEET:       |
| SAFETY:                  |            | AUTOCAD DRAWING |                 | Release   | 1 OF 8       |
| APPROVED: E5900525/TMK   |            | Common sheet    |                 |           |              |

F

EATON CORPORATION - CONFIDENTIAL AND PROPRIETARY  
NOTICE TO PERSONS RECEIVING THIS DOCUMENT AND/OR TECHNICAL INFORMATION

THIS DOCUMENT, INCLUDING THE DRAWING AND INFORMATION CONTAINED THEREON, IS CONFIDENTIAL AND IS THE EXCLUSIVE PROPERTY OF EATON CORPORATION, AND IS MERELY ON LOAN AND SUBJECT TO RECALL BY EATON AT ANY TIME. BY TAKING POSSESSION OF THIS DOCUMENT, THE RECIPIENT ACKNOWLEDGES AND AGREES THAT THIS DOCUMENT CANNOT BE USED IN ANY MANNER ADVERSE TO THE INTERESTS OF EATON AND THAT NO PORTION OF THIS DOCUMENT MAY BE COPIED OR OTHERWISE REPRODUCED WITHOUT THE PRIOR WRITTEN CONSENT OF EATON. IN THE CASE OF CONFLICTING CONTRACTUAL PROVISIONS, THIS NOTICE SHALL GOVERN THE STATUS OF THIS DOCUMENT.

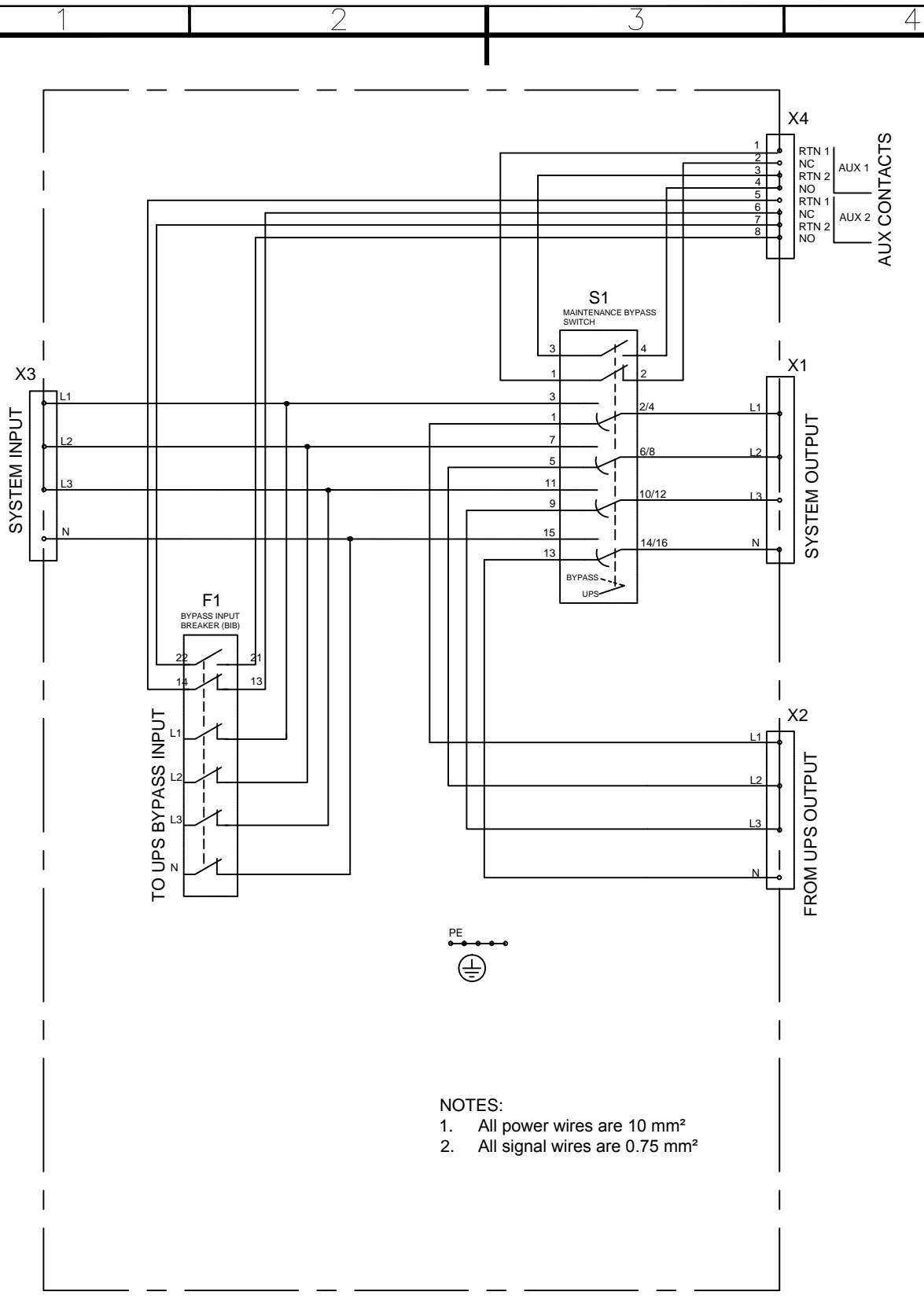

NOTES:

1. All power wires are 10 mm<sup>2</sup>
2. All signal wires are 0.75 mm<sup>2</sup>

METRIC



EATON CORPORATION



DIMENSIONS ARE IN MILLIMETERS AFTER PLATING, DIMENSIONS AND TOLERANCES IN ACCORDANCE WITH ASME Y14.5M-1994. SEE NOTES FOR TOLERANCES.

DESCRIPTION: EXTERNAL MBS 20kW, 3-SWITCHES

|                          |            |                    |                 |           |              |
|--------------------------|------------|--------------------|-----------------|-----------|--------------|
| ORIGINATED: E5900083 /JP | 15.05.2015 | ECO:               | NAME:           | REVISION: | SIZE: A4     |
| MODIFIED: E9917864/EY    | 18.09.2015 | ECO-089242         | P-105000044-003 | 002       | NOT TO SCALE |
| CHECKED: E5900525/TKM    |            | DOCUMENT TYPE:     |                 | STATE:    | SHEET:       |
| SAFETY:                  |            | AUTOCAD DRAWING    |                 | Release   | 2 OF 8       |
| APPROVED: E5900525/TKM   |            | Switchgear diagram |                 |           |              |

EATON CORPORATION - CONFIDENTIAL AND PROPRIETARY  
NOTICE TO PERSONS RECEIVING THIS DOCUMENT AND/OR TECHNICAL INFORMATION

THIS DOCUMENT, INCLUDING THE DRAWING AND INFORMATION CONTAINED THEREON, IS CONFIDENTIAL AND IS THE EXCLUSIVE PROPERTY OF EATON CORPORATION, AND IS MERELY ON LOAN AND SUBJECT TO RECALL BY EATON AT ANY TIME. BY TAKING POSSESSION OF THIS DOCUMENT, THE RECIPIENT ACKNOWLEDGES AND AGREES THAT THIS DOCUMENT CANNOT BE USED IN ANY MANNER ADVERSE TO THE INTERESTS OF EATON AND THAT NO PORTION OF THIS DOCUMENT MAY BE COPIED OR OTHERWISE REPRODUCED WITHOUT THE PRIOR WRITTEN CONSENT OF EATON. IN THE CASE OF CONFLICTING CONTRACTUAL PROVISIONS, THIS NOTICE SHALL GOVERN THE STATUS OF THIS DOCUMENT.

X = clearance at both sides of cabinet min. 50mm

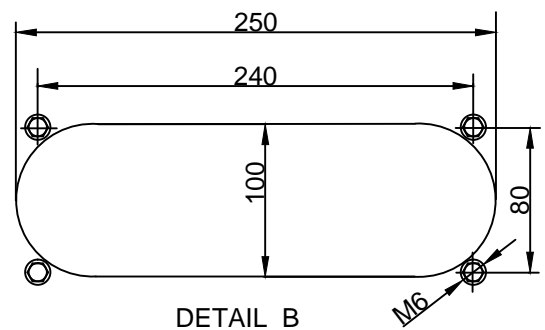
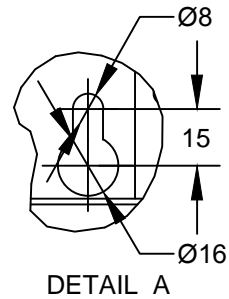
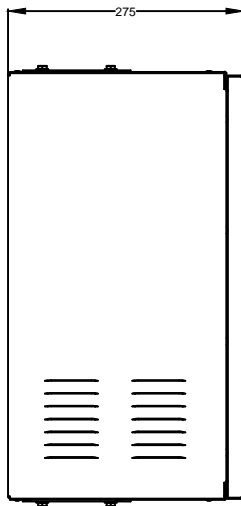
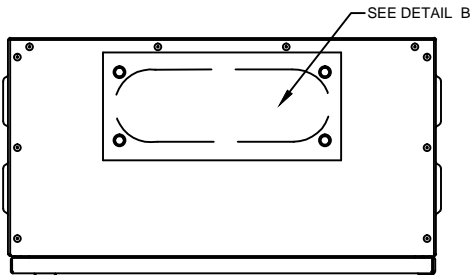
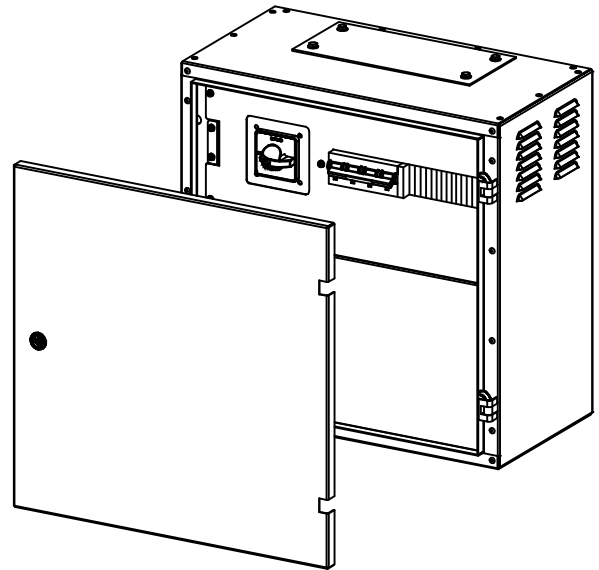
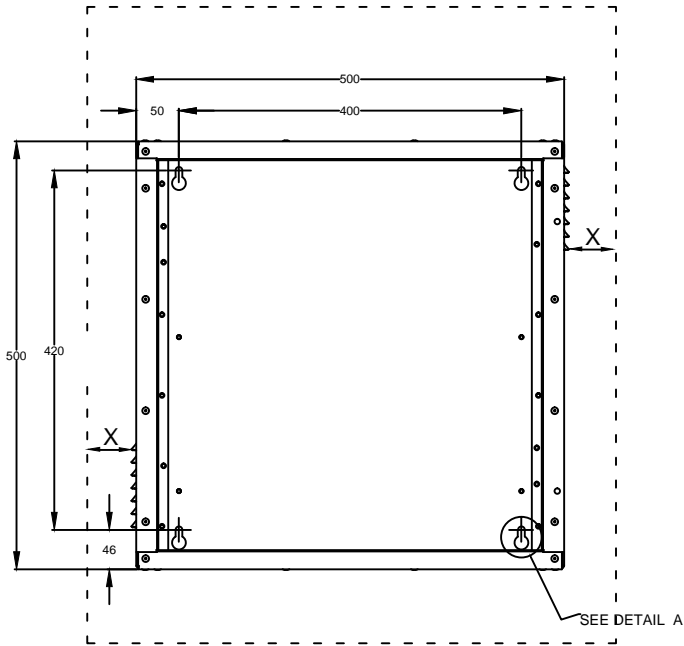

METRIC



EATON CORPORATION



DIMENSIONS ARE IN MILLIMETERS AFTER PLATING, DIMENSIONS AND TOLERANCES IN ACCORDANCE WITH ASME Y14.5M-1994. SEE NOTES FOR TOLERANCES.

DESCRIPTION: EXTERNAL MBS 20kW, 3-SWITCHES

|                          |            |                   |                 |           |              |
|--------------------------|------------|-------------------|-----------------|-----------|--------------|
| ORIGINATED: E5900085 /JP | 15.05.2015 | ECO:              | NAME:           | REVISION: | SIZE: A4     |
| MODIFIED: E9917864/EY    | 18.09.2015 | ECO-089242        | P-105000044-003 | 002       | NOT TO SCALE |
| CHECKED: E5900525/TKM    |            | DOCUMENT TYPE:    |                 | STATE:    | SHEET:       |
| SAFETY:                  |            | AUTOCAD DRAWING   |                 | Release   | 3 OF 8       |
| APPROVED: E5900525/TKM   |            | Dimension diagram |                 |           |              |

EATON CORPORATION - CONFIDENTIAL AND PROPRIETARY  
NOTICE TO PERSONS RECEIVING THIS DOCUMENT AND/OR TECHNICAL INFORMATION

THIS DOCUMENT, INCLUDING THE DRAWING AND INFORMATION CONTAINED THEREON, IS CONFIDENTIAL AND IS THE EXCLUSIVE PROPERTY OF EATON CORPORATION, AND IS MERELY ON LOAN AND SUBJECT TO RECALL BY EATON AT ANY TIME. BY TAKING POSSESSION OF THIS DOCUMENT, THE RECIPIENT ACKNOWLEDGES AND AGREES THAT THIS DOCUMENT CANNOT BE USED IN ANY MANNER ADVERSE TO THE INTERESTS OF EATON AND THAT NO PORTION OF THIS DOCUMENT MAY BE COPIED OR OTHERWISE REPRODUCED WITHOUT THE PRIOR WRITTEN CONSENT OF EATON. IN THE CASE OF CONFLICTING CONTRACTUAL PROVISIONS, THIS NOTICE SHALL GOVERN THE STATUS OF THIS DOCUMENT.

1 2 3 4

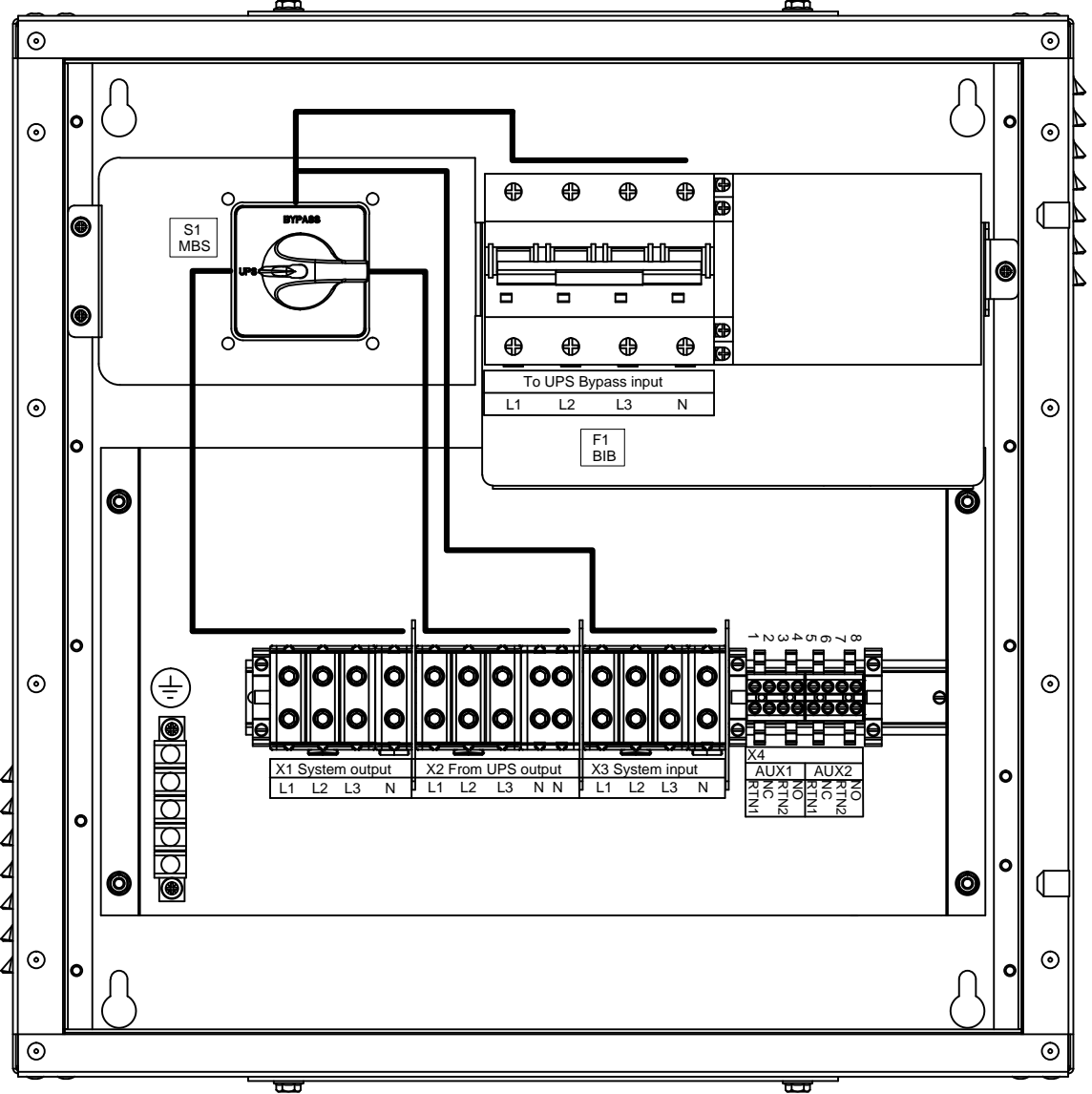
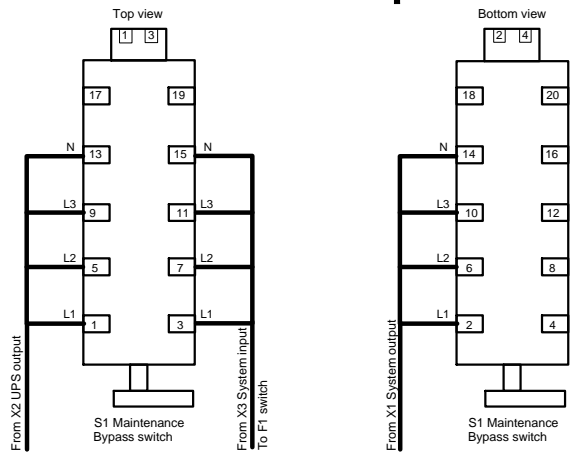

A  
B  
C  
D  
E

METRIC

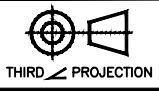

EATON CORPORATION



DIMENSIONS ARE IN MILLIMETERS AFTER PLATING, DIMENSIONS AND TOLERANCES IN ACCORDANCE WITH ASME Y14.5M-1994. SEE NOTES FOR TOLERANCES.

DESCRIPTION: EXTERNAL MBS 20kW, 3-SWITCHES

|                          |            |                   |                 |           |              |
|--------------------------|------------|-------------------|-----------------|-----------|--------------|
| ORIGINATED: E5900083 /JP | 15.05.2015 | ECO:              | NAME:           | REVISION: | SIZE: A4     |
| MODIFIED: E9917864/EY    | 18.09.2015 | ECO-089242        | P-105000044-003 | 002       | NOT TO SCALE |
| CHECKED: E5900525/TMK    |            | DOCUMENT TYPE:    |                 | STATE:    | SHEET:       |
| SAFETY:                  |            | AUTOCAD DRAWING   | Release         | 4 OF 8    |              |
| APPROVED: E5900525/TMK   |            | Component diagram |                 |           |              |

EATON CORPORATION - CONFIDENTIAL AND PROPRIETARY  
NOTICE TO PERSONS RECEIVING THIS DOCUMENT AND/OR TECHNICAL INFORMATION

THIS DOCUMENT, INCLUDING THE DRAWING AND INFORMATION CONTAINED THEREON, IS CONFIDENTIAL AND IS THE EXCLUSIVE PROPERTY OF EATON CORPORATION, AND IS MERELY ON LOAN AND SUBJECT TO RECALL BY EATON AT ANY TIME. BY TAKING POSSESSION OF THIS DOCUMENT, THE RECIPIENT ACKNOWLEDGES AND AGREES THAT THIS DOCUMENT CANNOT BE USED IN ANY MANNER ADVERSE TO THE INTERESTS OF EATON AND THAT NO PORTION OF THIS DOCUMENT MAY BE COPIED OR OTHERWISE REPRODUCED WITHOUT THE PRIOR WRITTEN CONSENT OF EATON. IN THE CASE OF CONFLICTING CONTRACTUAL PROVISIONS, THIS NOTICE SHALL GOVERN THE STATUS OF THIS DOCUMENT.

1 2 3 4

A

B

C

D

E

F

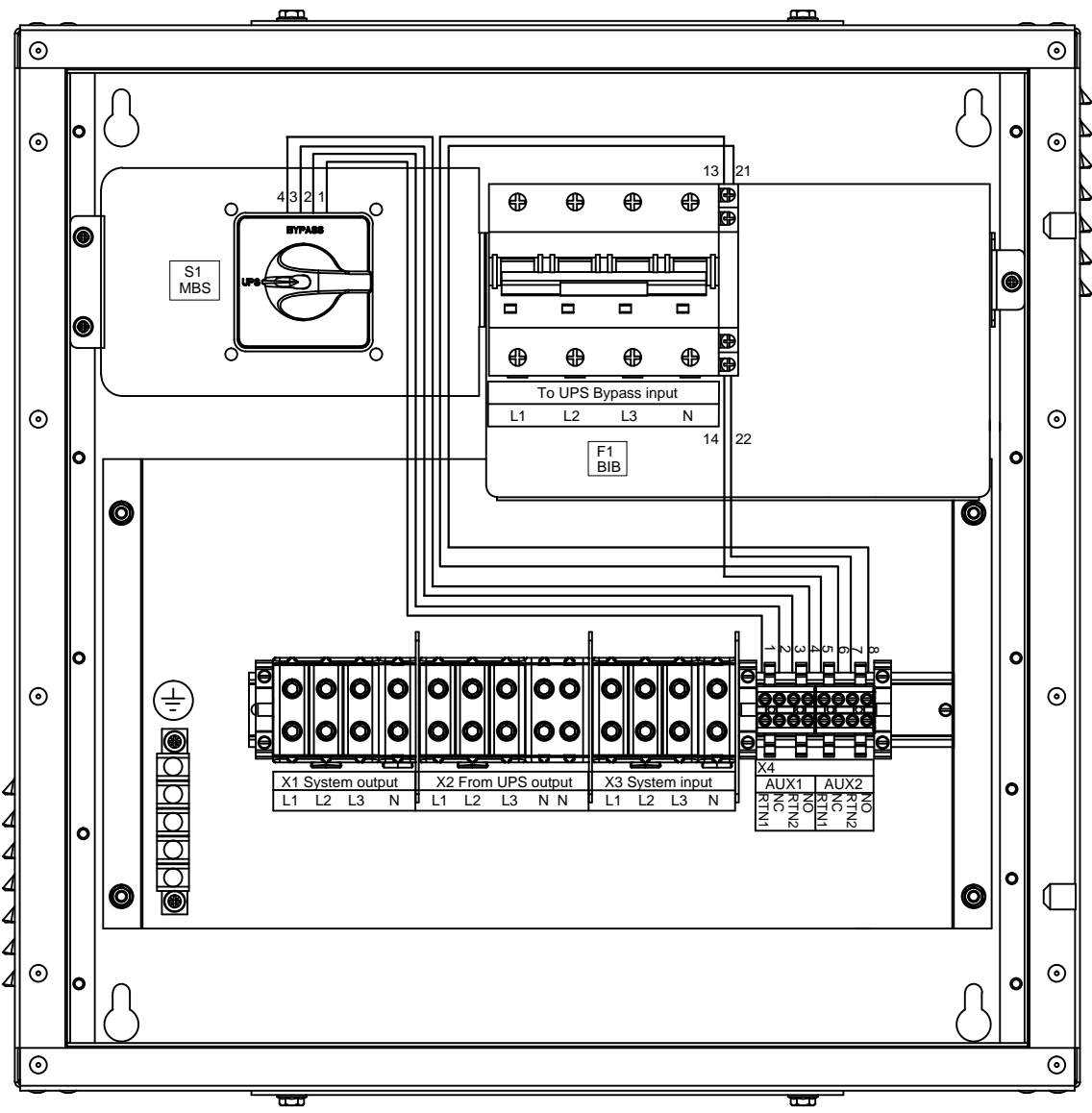

METRIC

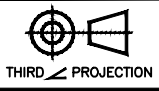

EATON CORPORATION



DIMENSIONS ARE IN MILLIMETERS AFTER PLATING, DIMENSIONS AND TOLERANCES IN ACCORDANCE WITH ASME Y14.5M-1994. SEE NOTES FOR TOLERANCES.

DESCRIPTION: EXTERNAL MBS 20kW, 3-SWITCHES

|                          |            |                        |                 |           |              |
|--------------------------|------------|------------------------|-----------------|-----------|--------------|
| ORIGINATED: E5900083 /JP | 15.05.2015 | ECO:                   | NAME:           | REVISION: | SIZE: A4     |
| MODIFIED: E9917864/EY    | 18.09.2015 | ECO-089242             | P-105000044-003 | 002       | NOT TO SCALE |
| CHECKED: E5900525/TMK    |            | DOCUMENT TYPE:         |                 | STATE:    | SHEET:       |
| SAFETY:                  |            | AUTOCAD DRAWING        |                 | Release   | 5 OF 8       |
| APPROVED: E5900525/TMK   |            | Control wiring Diagram |                 |           |              |

EATON CORPORATION - CONFIDENTIAL AND PROPRIETARY  
 NOTICE TO PERSONS RECEIVING THIS DOCUMENT AND/OR TECHNICAL INFORMATION

THIS DOCUMENT, INCLUDING THE DRAWING AND INFORMATION CONTAINED THEREON, IS CONFIDENTIAL AND IS THE EXCLUSIVE PROPERTY OF EATON CORPORATION, AND IS MERELY ON LOAN AND SUBJECT TO RECALL BY EATON AT ANY TIME. BY TAKING POSSESSION OF THIS DOCUMENT, THE RECIPIENT ACKNOWLEDGES AND AGREES THAT THIS DOCUMENT CANNOT BE USED IN ANY MANNER ADVERSE TO THE INTERESTS OF EATON AND THAT NO PORTION OF THIS DOCUMENT MAY BE COPIED OR OTHERWISE REPRODUCED WITHOUT THE PRIOR WRITTEN CONSENT OF EATON. IN THE CASE OF CONFLICTING CONTRACTUAL PROVISIONS, THIS NOTICE SHALL GOVERN THE STATUS OF THIS DOCUMENT.

**A TECHNICAL SPECIFICATION**

STANDARD IEC/EN 61439-2

MAINS TN-S, 5W/3P+N+PE, 380/400/415VAC 3~

- 1. Nominal Voltage  $U_n$  380/400/415 V
- 2. Nominal Current  $I_{nA}$  30/29/28 A
- 3. Maximum Current  $I_{max}$  36 A
- 4. Nominal Frequency  $f_n$  50/60 Hz
- 5. Operating Temperature  $T$  max +40 °C
- 6. Current capability
  - Thermal  $I_{cc}$  10 kA \*
  - Dynamical  $I_{pk}$      kA
- 7. Power dissipation  $P$      W
- 8. Electrical Wiring AC
  - L1
  - L2
  - L3
  - N
  - PE
  - PEN

**TYPE PLATE, SAMPLE**

80

EXTERNAL MBS 20kW, 3-SWITCHES

|            |                        |       |                |
|------------|------------------------|-------|----------------|
| Part Nr:   | <u>P-105000044-003</u> | Rev:  | <u>002</u>     |
| Serial Nr: | <u>00001</u>           | Date: | <u>05/2015</u> |

56

|          |                      |         |              |
|----------|----------------------|---------|--------------|
| MAINS:   | <u>TN-S</u>          | WEIGHT: | <u>26 kg</u> |
| CLASS:   | <u>IP21</u>          |         |              |
| $U_n$    | <u>380/400/415 V</u> |         |              |
| $I_{nA}$ | <u>30/29/28 A</u>    |         |              |
| $f_n$    | <u>50/60 Hz</u>      |         |              |
| $I_{cc}$ | <u>10 kA</u>         |         |              |

IEC61439-2 Made in EU

**CONSTRUCTION OF SWITCHGEAR**

- 1. Enclosure Class  $IP$  21
  - Outfield location
  - Interior location
- 2. Installation
  - Surficial
  - Wall mounting
  - Floor mounting
- 3. Additional door
  - Lock-up
- 4. Color
  - Common color RAL7035
  - Custom color Eaton dwg
- 5. Cabling entry 164700509-001
  - Top entry
  - Bottom entry
  - Conduit flange of cable
- 6. Material specification
  - Cable material 90°C, H07V2-K
  - Cable U/Uo 450/750
  - Cover material
  - Other demand
- 7. Handle location Door handle
  - 
  - 
  - 
  -

**Note !**

- 1. Back-up fuse required for system input 40A gG
- 2. For external wiring use wire with temperature class min +90°C
- 3. \_\_\_\_\_
- 4. \_\_\_\_\_
- 5. \_\_\_\_\_

**C CUSTOMER ELECTRICAL INFORMATION**

- 1. MAINS
  - TN-C-S
  - TN-S
  - IT
- 2. LOAD POWER
  - S      kVA
  - P      kW
  - p.f.

|   |                            |                                |                       |
|---|----------------------------|--------------------------------|-----------------------|
| METRIC  | <br>THIRD ANGLE PROJECTION | EATON CORPORATION              |                       |
| DIMENSIONS ARE IN MILLIMETERS AFTER PLATING, DIMENSIONS AND TOLERANCES IN ACCORDANCE WITH ASME Y14.5M-1994. SEE NOTES FOR TOLERANCES. |                            |                                |                       |
| DESCRIPTION: EXTERNAL MBS 20kW, 3-SWITCHES  |                            |                                |                       |
| ORIGINATED: E5900083 /JP  | 15.05.2015                 | ECO: ECO-089242                | NAME: P-105000044-003 |
| MODIFIED: E9917864/EY   | 18.09.2015                 | DOCUMENT TYPE: AUTOCAD DRAWING | REVISION: 002         |
| CHECKED: E5900525/TKM   |                            |                                | STATE: Release        |
| SAFETY:   |                            |                                | SHEET: 6 OF 8         |
| APPROVED: E5900525/TKM  |                            | General information            |                       |

EATON CORPORATION - CONFIDENTIAL AND PROPRIETARY  
 NOTICE TO PERSONS RECEIVING THIS DOCUMENT AND/OR TECHNICAL INFORMATION  
 THIS DOCUMENT, INCLUDING THE DRAWING AND INFORMATION CONTAINED THEREON, IS CONFIDENTIAL AND IS THE EXCLUSIVE PROPERTY OF EATON CORPORATION, AND IS MERELY ON LOAN AND SUBJECT TO RECALL BY EATON AT ANY TIME.  
 BY TAKING POSSESSION OF THIS DOCUMENT, THE RECIPIENT ACKNOWLEDGES AND AGREES THAT THIS DOCUMENT CANNOT BE USED IN ANY MANNER ADVERSE TO THE INTERESTS OF EATON AND THAT NO PORTION OF THIS DOCUMENT MAY BE COPIED OR OTHERWISE REPRODUCED WITHOUT THE PRIOR WRITTEN CONSENT OF EATON. IN THE CASE OF CONFLICTING CONTRACTUAL PROVISIONS, THIS NOTICE SHALL GOVERN THE STATUS OF THIS DOCUMENT.  
 © 2011 Eaton Corporation - All Rights Reserved.

### Turn UPS from NORMAL MODE to MECHANICAL BYPASS

1. The start position is following:

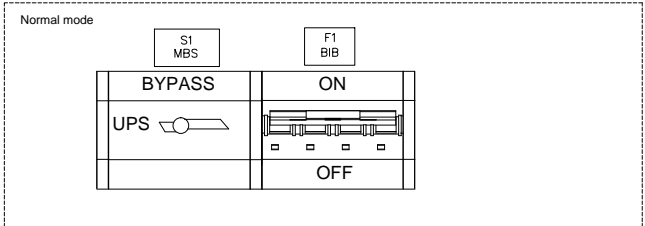

2. Use UPS display to turn the UPS on internal static bypass mode. Remember to verify the transfer before proceeding the next step.

3. Turn the MBS (S1) to bypass position to bypass UPS:

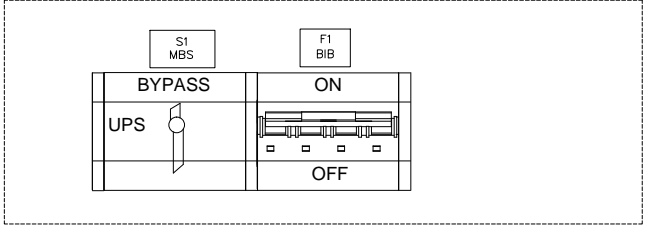

4. Use UPS display to turn UPS OFF.

5. Turn the UPS Battery Breaker (CB1) if not automatically tripped and UPS Rectifier Input Switch (S1) to OFF position.

6. Turn OFF the BIB (F1) to disconnect UPS from bypass and rectifier input:

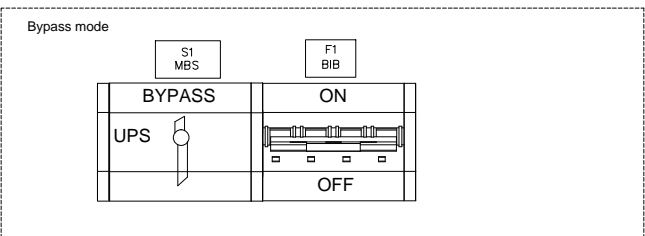

7. Use the external isolator to isolate the UPS rectifier input before maintaining the UPS, unless the UPS is supplied from a single feed.

METRIC



EATON CORPORATION



DIMENSIONS ARE IN MILLIMETERS AFTER PLATING, DIMENSIONS AND TOLERANCES IN ACCORDANCE WITH ASME Y14.5M-1994. SEE NOTES FOR TOLERANCES.

DESCRIPTION: EXTERNAL MBS 20kW, 3-SWITCHES

|                          |            |                        |                 |           |              |
|--------------------------|------------|------------------------|-----------------|-----------|--------------|
| ORIGINATED: E5900083 /JP | 15.05.2015 | ECO:                   | NAME:           | REVISION: | SIZE: A4     |
| MODIFIED: E9917864/EY    | 19.09.2015 | ECO-089242             | P-105000044-003 | 002       | NOT TO SCALE |
| CHECKED: E5900525/TKM    |            | DOCUMENT TYPE:         |                 | STATE:    | SHEET:       |
| SAFETY:                  |            | AUTOCAD DRAWING        |                 | Release   | 7 OF 8       |
| APPROVED: E5900525/TKM   |            | Operating Instructions |                 |           |              |

EATON CORPORATION - CONFIDENTIAL AND PROPRIETARY  
NOTICE TO PERSONS RECEIVING THIS DOCUMENT AND/OR TECHNICAL INFORMATION

THIS DOCUMENT, INCLUDING THE DRAWING AND INFORMATION CONTAINED THEREON, IS CONFIDENTIAL AND IS THE EXCLUSIVE PROPERTY OF EATON CORPORATION, AND IS MERELY ON LOAN AND SUBJECT TO RECALL BY EATON AT ANY TIME. BY TAKING POSSESSION OF THIS DOCUMENT, THE RECIPIENT ACKNOWLEDGES AND AGREES THAT THIS DOCUMENT CANNOT BE USED IN ANY MANNER ADVERSE TO THE INTERESTS OF EATON AND THAT NO PORTION OF THIS DOCUMENT MAY BE COPIED OR OTHERWISE REPRODUCED WITHOUT THE PRIOR WRITTEN CONSENT OF EATON. IN THE CASE OF CONFLICTING CONTRACTUAL PROVISIONS, THIS NOTICE SHALL GOVERN THE STATUS OF THIS DOCUMENT.

## Turn UPS from MECHANICAL BYPASS to NORMAL MODE

- The start position is following:

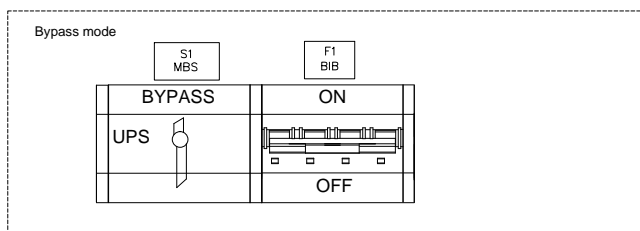

- Turn ON the BIB (F1) to connect Bypass and rectifier input to UPS:

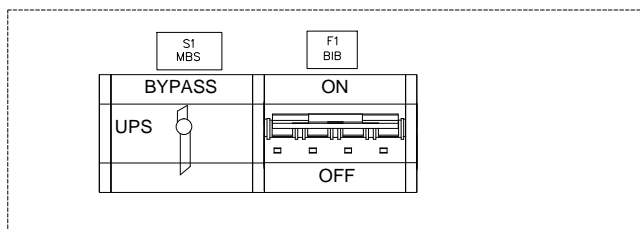

- Use the external isolator to restore rectifier feed to the UPS, unless the UPS is supplied from a single feed.
- Turn the UPS Battery Breaker (CB1) and UPS Rectifier Input Switch (S1) to ON position.
- Use UPS display to transfer the UPS to static bypass and give "Start Module" command to start the UPS(s) to "ready"-state.
  - Make sure the UPS is not displaying any alarms or notices.
  - You may verify the output voltage from the meters screen of the display.
- Turn the MBS (S1) to UPS position to switch the output to UPS:

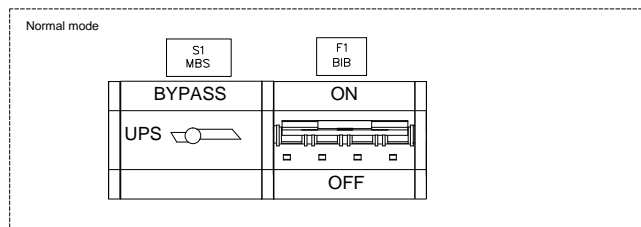

- Use UPS display to transfer the UPS to normal mode (Give "Go Online"- command in the "Controls"-menu). Verify the UPS is running in "Normal"-mode, green LED is lit, status is displayed "Online" and no alarms are present.

METRIC



EATON CORPORATION



DIMENSIONS ARE IN MILLIMETERS AFTER PLATING, DIMENSIONS AND TOLERANCES IN ACCORDANCE WITH ASME Y14.5M-1994. SEE NOTES FOR TOLERANCES.

DESCRIPTION: EXTERNAL MBS 20kW, 3-SWITCHES

|                          |            |                        |                 |           |              |
|--------------------------|------------|------------------------|-----------------|-----------|--------------|
| ORIGINATED: E5900083 /JP | 15.05.2015 | ECO:                   | NAME:           | REVISION: | SIZE: A4     |
| MODIFIED: E9917864/EY    | 18.09.2015 | ECO-089242             | P-105000044-003 | 002       | NOT TO SCALE |
| CHECKED: E5900525/TKM    |            | DOCUMENT TYPE:         |                 | STATE:    | SHEET:       |
| SAFETY:                  |            | AUTOCAD DRAWING        | Release         | 8 OF 8    |              |
| APPROVED: E5900525/TKM   |            | Operating Instructions |                 |           |              |

EATON CORPORATION - CONFIDENTIAL AND PROPRIETARY  
NOTICE TO PERSONS RECEIVING THIS DOCUMENT AND/OR TECHNICAL INFORMATION

THIS DOCUMENT, INCLUDING THE DRAWING AND INFORMATION CONTAINED THEREON, IS CONFIDENTIAL AND IS THE EXCLUSIVE PROPERTY OF EATON CORPORATION, AND IS MERELY ON LOAN AND SUBJECT TO RECALL BY EATON AT ANY TIME. BY TAKING POSSESSION OF THIS DOCUMENT, THE RECIPIENT ACKNOWLEDGES AND AGREES THAT THIS DOCUMENT CANNOT BE USED IN ANY MANNER ADVERSE TO THE INTERESTS OF EATON AND THAT NO PORTION OF THIS DOCUMENT MAY BE COPIED OR OTHERWISE REPRODUCED WITHOUT THE PRIOR WRITTEN CONSENT OF EATON. IN THE CASE OF CONFLICTING CONTRACTUAL PROVISIONS, THIS NOTICE SHALL GOVERN THE STATUS OF THIS DOCUMENT.

© 2011 Eaton Corporation - All Rights Reserved.