

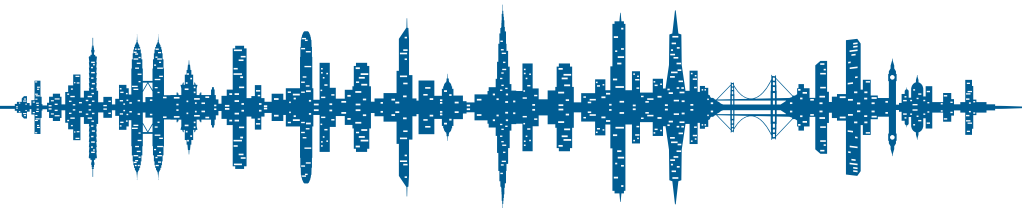

plantronics®

Electronic Hook Switch Guide

Summer 2012



SAVI® 700 SERIES | CS500™ SERIES | MDA200™

Electronic Hook Switch Guide Contents

Electronic Hook Switch Cables (EHS) provide remote desk phone call control (answer/end) with your Plantronics wireless headset system (or the MDA200™ headset hub). We offer cables that are compatible with many of the most popular office desk phones.

We also have a handset lifter accessory that can be used with most desk phones that are not compatible with one of our EHS cables.

Visit Plantronics.com for more information.



1
Aastra Phone Models



9
Polycom Phone Models



2
Alcatel-Lucent Phone Models



10
Siemens Phone Models



3
Agfeo Phone Models



11
Tenovis Phone Models



4
Avaya Phone Models



12
T-Systems Phone Models



6
Cisco Phone Models



14
TipeL Phone Models



8
Funkwerk Phone Models



15
Snom Phone Models

Electronic Hook Switch for Aastra®

Aastra

Desk Phone Models

- 6739i
- 6753i
- 6755i
- 6757i
- 6757i CT
- Aastra 6771
- Aastra 6773
- Aastra 6775
- Aastra 6773 IP
- Aastra 6775 IP
- Aastra 5370
- Aastra 5380
- Aastra 5370 IP
- Aastra 5380 IP



EHS Cable

APS-11*
PN: 37818-11

** APS-11 replaces APS-10*



Plantronics Audio Solutions

Savi® 700 Series
Wireless headset system manages PC, mobile and desk phone calls

CS500™ Series
Wireless headsets manage desk phone calls

MDA200™
Enables USB connectivity to the desk phone to manage both PC and desk phone calls

EHS Setup Use the EHS setup below to automatically answer a desk phone call by pressing a button on your Savi 700 Series or CS500 Series headset or MDA200.

Aastra models: 6753i, 6755i, 6757i, 6757i CT

Setup

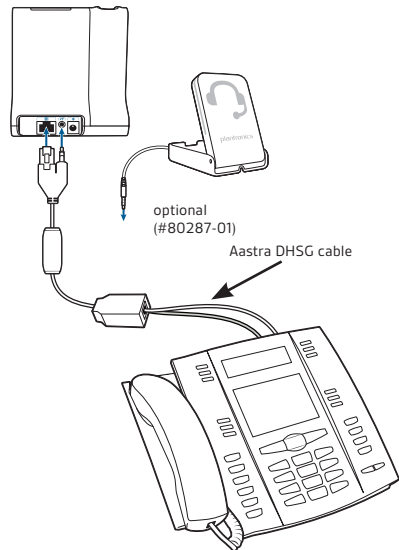

Aastra models: 6771, 6113, 6775, 6773 IP, 6775 IP, 5370, 5380, 5370 IP, 5380 IP, 6739i

Setup

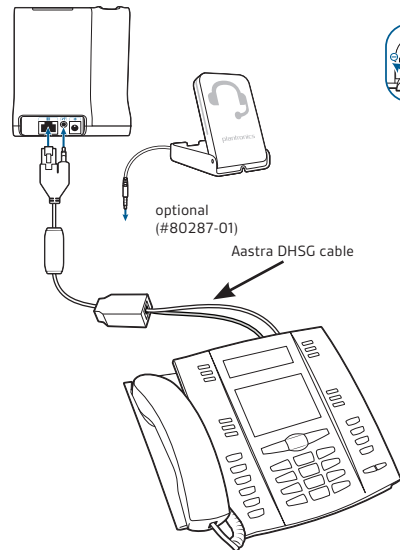

Configuration

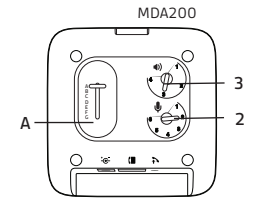
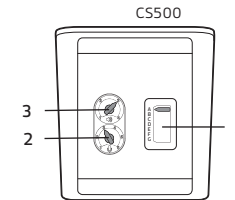
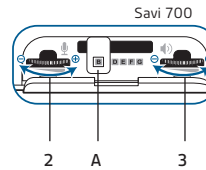

Only the Aastra DHSG cable should be connected directly to your phone. No 3rd party DHSG cables should be connected directly to the Aastra IP phone.

Electronic Hook Switch for Alcatel-Lucent

Alcatel-Lucent 



Desk Phone Models
 IP Touch 4028, IP Touch 4038, IP Touch 4068, Touch 4029, Touch 4039, My IC 8082

+

EHS Cable



APA-23*
 PN: 38908-11

*APA-23 replaces APA-20 and APA-22

+

Plantronics Audio Solutions



Savi 700 Series
 Wireless headset system manages PC, mobile and desk phone calls



CS500 Series
 Wireless headsets manage desk phone calls



MDA200
 Enables USB connectivity to the desk phone to manage both PC and desk phone calls

EHS Setup Use the EHS setup below to automatically answer a desk phone call by pressing a button on your Savi 700 Series or CS500 Series headset or MDA200.

Alcatel-Lucent models: IP Touch 4028, 4038, 4068

Setup

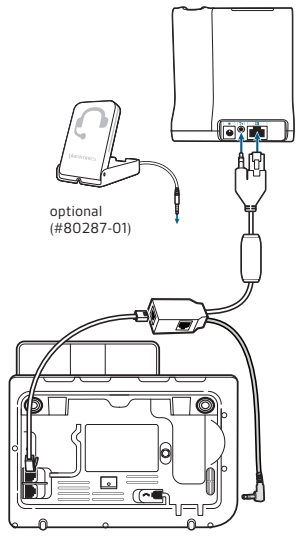

Configuration

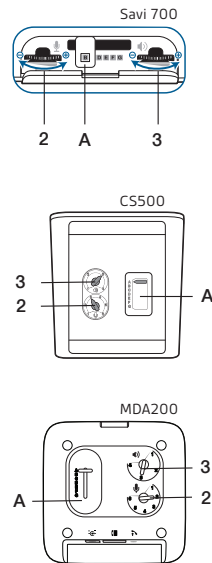

Alcatel-Lucent models: Touch 4029, 4039

Setup

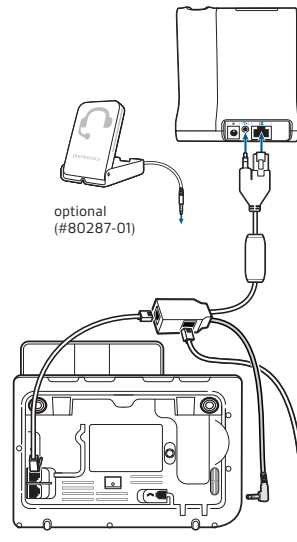

Configuration

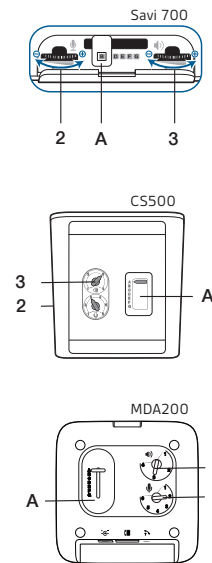

Alcatel-Lucent models: My IC 8082

Setup

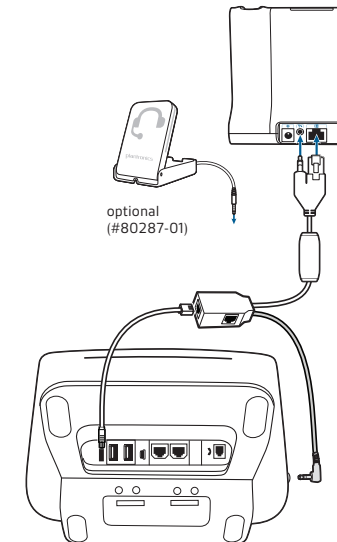

Configuration

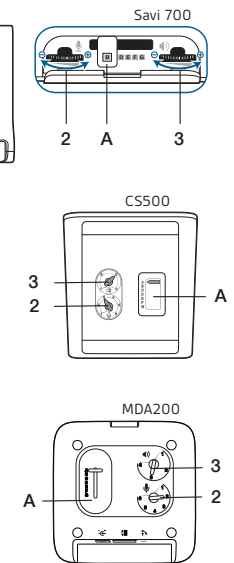

Electronic Hook Switch for Agfeo

AGFEO
einfach | perfekt | kommunizieren

Desk Phone Models
ST31
ST40
ST40IP



+

EHS Cable



APS-11*
PN: 37818-11

*APS-11 replaces APS-10

+

Plantronics Audio Solutions



Savi 700 Series
Wireless headset system manages PC, mobile and desk phone calls

CS500 Series
Wireless headsets manage desk phone calls

MDA200
Enables USB connectivity to the desk phone to manage both PC and desk phone calls

EHS Setup Use the EHS setup below to automatically answer a desk phone call by pressing a button on your Savi 700 Series or CS500 Series headset or MDA200.

Agfeo models: ST31, ST40, ST40IP

Setup

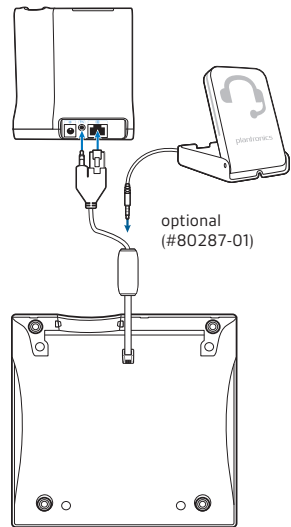

Configuration

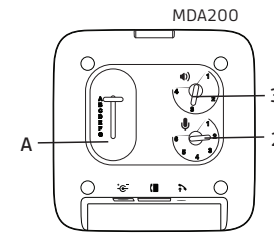
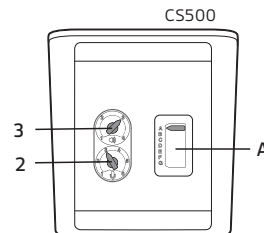
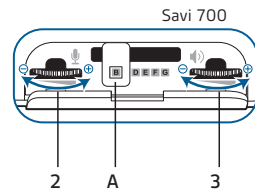

Electronic Hook Switch for Avaya®

AVAYA



APV-63 Cable

1408	9608	9670
1416	9611	9620L
1608	9620	2410
1616	9621	4630
9404	9630	6416D+M
9406	9640	6424D+M
9504	9641G	
9508	9650	

APV-66 Cable

2420	4621SW	5420
4610	4622SW	5610
4610SW	4625SW	5620
4620	4630SW	5621
4620SW		

+

EHS Cable

APV-63*
PN: 38734-11



APV-66*
PN: 38633-11



* APV-63 replaces APV-62; APV-66 replaces APV-65

+

Plantronics Audio Solutions



Savi 700 Series
Wireless headset system manages PC, mobile and desk phone calls



CS500 Series
Wireless headsets manage desk phone calls



MDA200
Enables USB connectivity to the desk phone to manage both PC and desk phone calls

EHS Setup Use the EHS setup below to automatically answer a desk phone call by pressing a button on your Savi 700 Series or CS500 Series headset or MDA200.

Avaya models: 1408, 1416, 1608, 1616, 9404, 9406, 9504, 9508, 9608, 9611, 9620, 9621, 9630, 9640, 9641G, 9650, 9670, 9620L

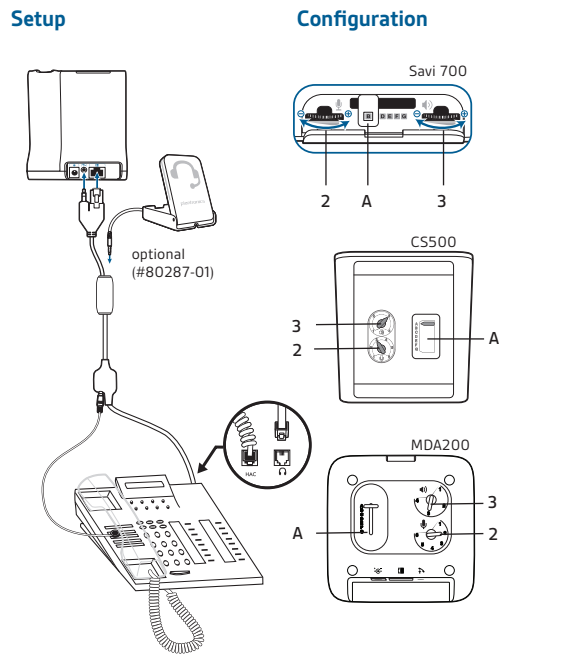

Avaya models: 2410, 4630, 6416D+M, 6424D+M

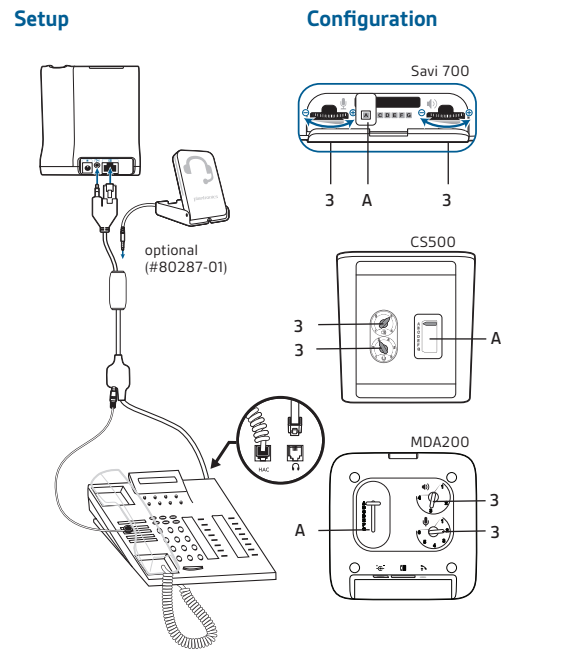

Avaya models: 2420, 4610, 4610SW, 4620, 4620SW, 4621SW, 4622SW, 4625SW, 4630SW, 5420, 5610, 5620, 5621

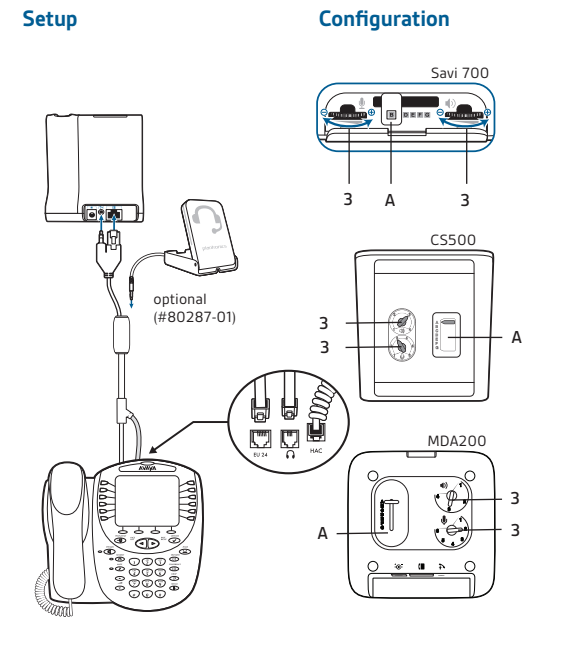

Electronic Hook Switch for Avaya – Nortel®

NORTEL



Desk Phone Models
 1120E 1150E
 1140E 1165E

+

EHS Cable



APU-71*
 PN: 83018-11

* APU-71 replaces APU-70

+

Plantronics Audio Solutions



Savi 700 Series
 Wireless headset system manages PC, mobile and desk phone calls



CS500 Series
 Wireless headsets manage desk phone calls



MDA200
 Enables USB connectivity to the desk phone to manage both PC and desk phone calls

EHS Setup Use the EHS setup below to automatically answer a desk phone call by pressing a button on your Savi 700 Series or CS500 Series headset or MDA200.

Nortel models: 1120E, 1140E, 1150E, 1165E

Setup

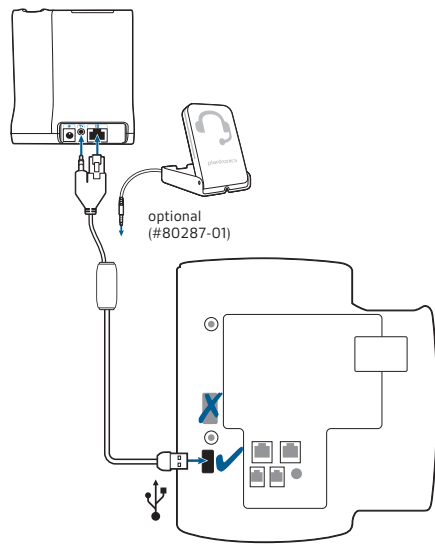

Configuration

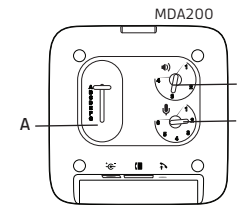
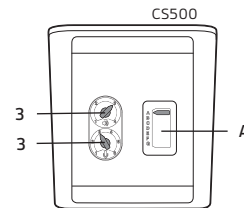
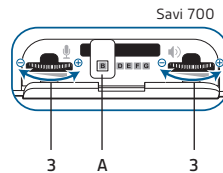

Electronic Hook Switch for Cisco®



APC-41 Cable
7942G
7945G
7962G
7965G
7975G

APU-71 Cable
8961
9951
9971

EHS Cable

APC-41*
PN: 38350-11

APU-71*
PN: 83018-11

* APC-41 replaces APC-40; APU-71 has replaced APU-70



Plantronics Audio Solutions



Savi 700 Series
Wireless headset system manages PC, mobile and desk phone calls

CS500 Series
Wireless headsets manage desk phone calls

MDA200
Enables USB connectivity to the desk phone to manage both PC and desk phone calls

EHS Setup Use the EHS setup below to automatically answer a desk phone call by pressing a button on your Savi 700 Series or CS500 Series headset or MDA200.

Cisco models: 7942G, 7945G, 7962G, 7965G, 7975G

Setup

Configuration

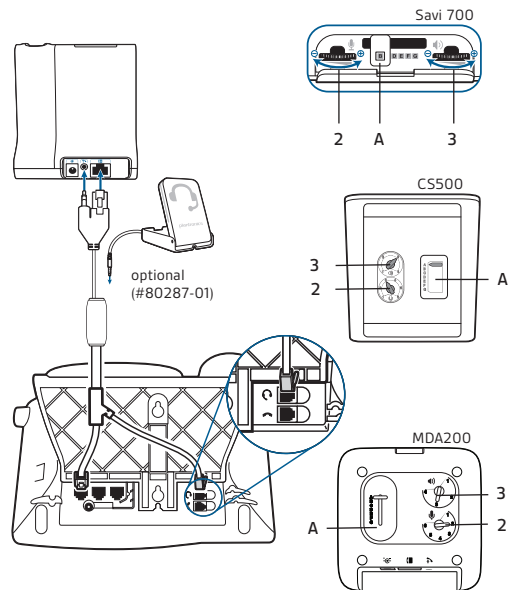

Cisco models: 7942G, 7945G, 7962G, 7965G, 7975G

Setup

Configuration

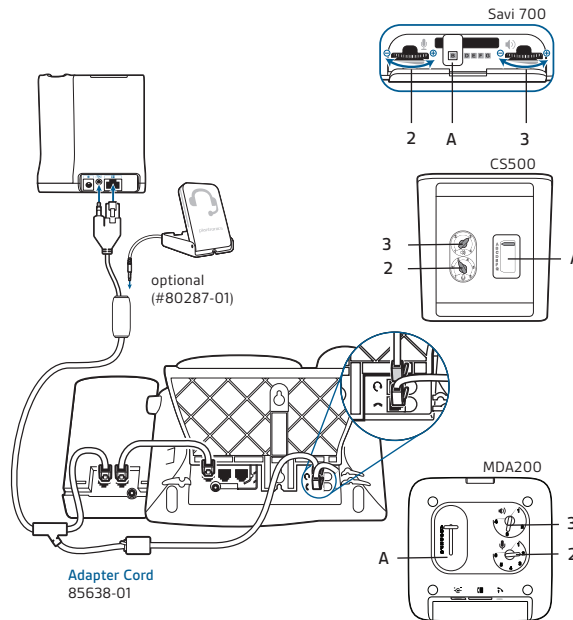

Cisco models: 8961, 9951, 9971

Setup

Configuration

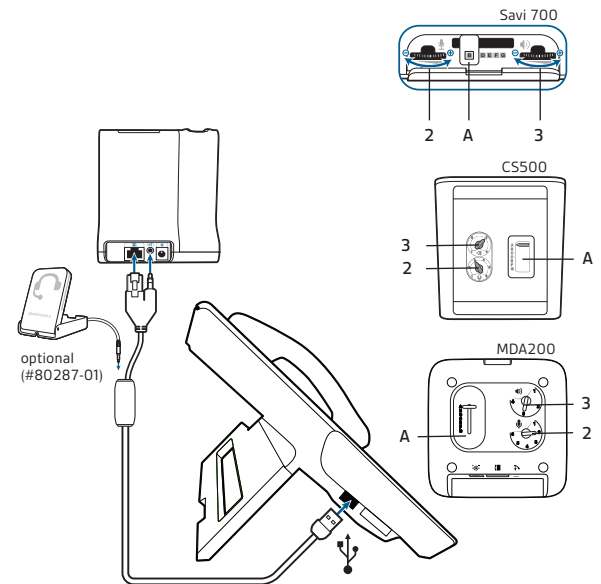

Electronic Hook Switch for Cisco®



CISCO

APC-45 Cable
SPA512
SPA514
SPA525G2

+

EHS Cable

APC-45
P/N: 87317-01



+

Plantronics Audio Solutions



Savi 700 Series
Wireless headset system manages PC, mobile and desk phone calls

CS500 Series
Wireless headsets manage desk phone calls

MDA200
Enables USB connectivity to the desk phone to manage both PC and desk phone calls

EHS Setup Use the EHS setup below to automatically answer a desk phone call by pressing a button on your Savi 700 Series or CS500 Series headset or MDA200.

Cisco models: SPA512, SPA514, SPA525G2

Setup

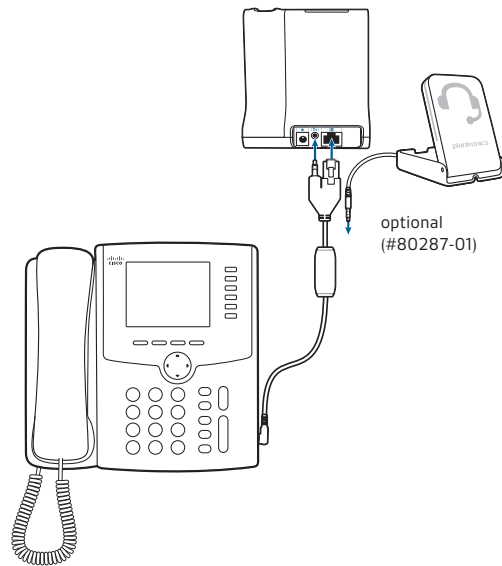

Configuration

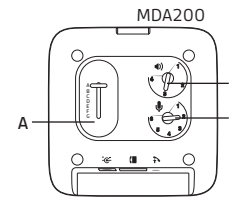
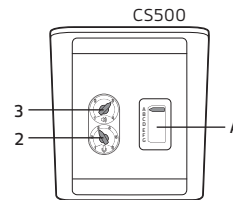
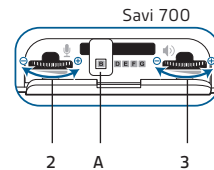

Electronic Hook Switch for Funkwerk

funkwerk
enterprise communications

Desk Phone Models
CS410
CS410-U
IP-S400
CS290-U
IP290 plus



+

EHS Cable



APS-11*
PN: 37818-11

* APS-11 replaces APS-10

+

Plantronics Audio Solutions



Savi 700 Series
Wireless headset system manages PC, mobile and desk phone calls

CS500 Series
Wireless headsets manage desk phone calls

MDA200
Enables USB connectivity to the desk phone to manage both PC and desk phone calls

EHS Setup Use the EHS setup below to automatically answer a desk phone call by pressing a button on your Savi 700 Series or CS500 Series headset or MDA200.

Funkwerk models: CS410, CS410-U, IP-S400, CS290-U, IP290 plus

Setup

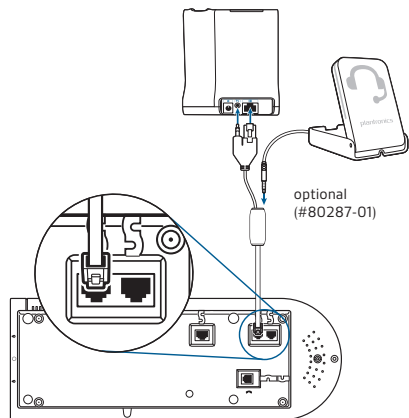

Configuration

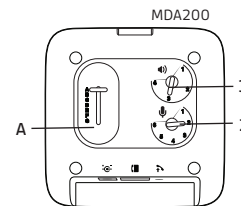
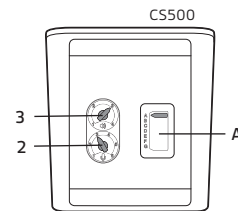
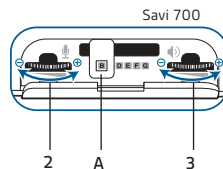

Electronic Hook Switch for Polycom®

POLYCOM®

Desk Phone Models

- SoundPoint® IP 320
- SoundPoint IP 321
- SoundPoint IP 330
- SoundPoint IP 331
- SoundPoint IP 335
- SoundPoint IP 430
- SoundPoint IP 450
- SoundPoint IP 550
- SoundPoint IP 560
- SoundPoint IP 650
- SoundPoint IP 670
- VVX500
- VVX1500



+

EHS Cable



APP-51*
PN: 38439-11

* APP-51 replaces APP-50

+

Plantronics Audio Solutions



Savi 700 Series
Wireless headset system manages PC, mobile and desk phone calls

CS500 Series
Wireless headsets manage desk phone calls

MDA200
Enables USB connectivity to the desk phone to manage both PC and desk phone calls

EHS Setup Use the EHS setup below to automatically answer a desk phone call by pressing a button on your Savi 700 Series or CS500 Series headset or MDA200.

Polycom models: SoundPoint IP 320, 321, 330, 331, 335, 430, 450, 550, 560, 650, 670, VVX500, VVX1500

Setup

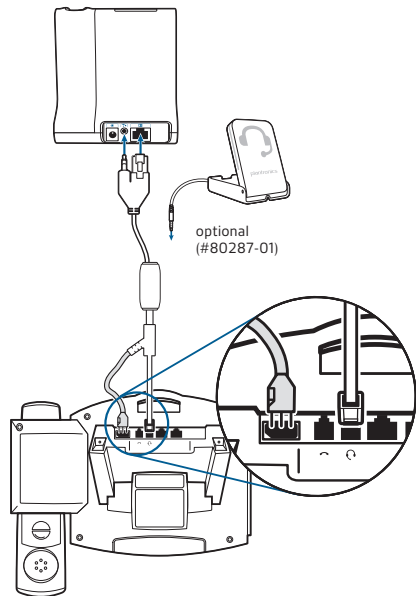

Configuration

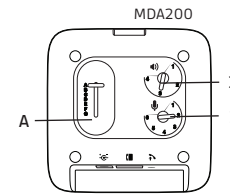
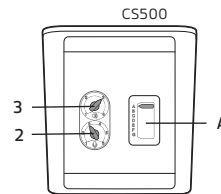
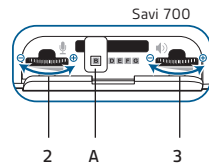

Electronic Hook Switch for Siemens®

SIEMENS



Desk Phone Models

Optipoint 410	OpenStage 40
Optipoint 420	OpenStage 60
Optipoint 500	OpenStage 80
Optipoint 600	



EHS Cable



APS-11*
PN: 37818-11

* APS-11 replaces APS-10



Plantronics Audio Solutions



Savi 700 Series
Wireless headset system manages PC, mobile and desk phone calls

CS500 Series
Wireless headsets manage desk phone calls

MDA200
Enables USB connectivity to the desk phone to manage both PC and desk phone calls

EHS Setup Use the EHS setup below to automatically answer a desk phone call by pressing a button on your Savi 700 Series or CS500 Series headset or MDA200.

Siemens models: Optipoint 410, 420, 500, 600

Setup

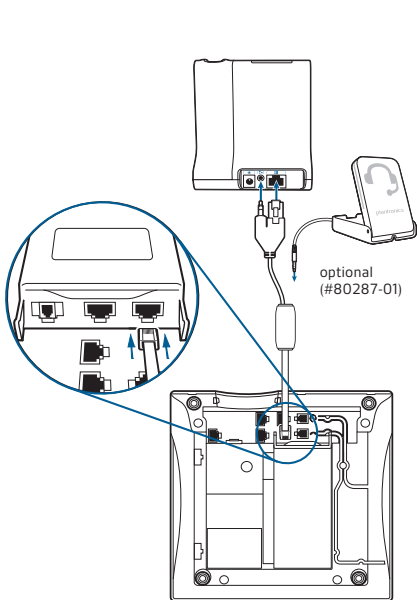

Configuration

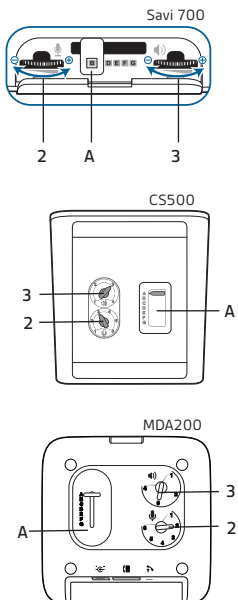

Siemens models: OpenStage 40, 60, 80

Setup

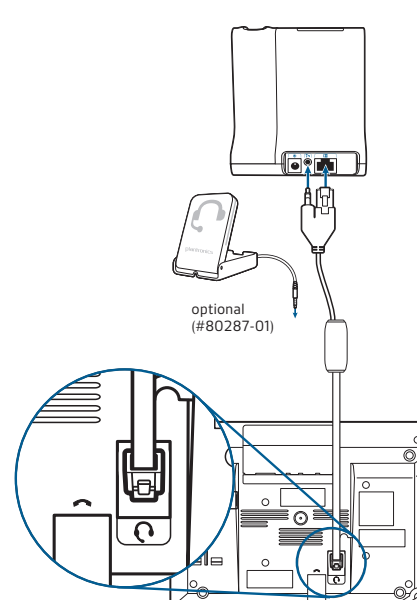

Configuration

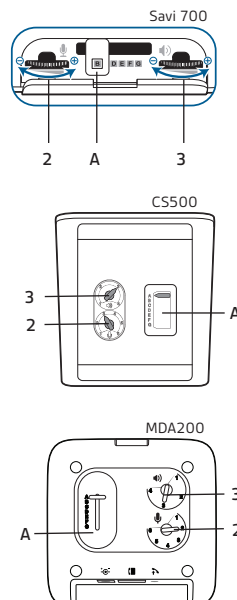

Electronic Hook Switch for Tenovis

TENOVIS

Desk Phone Models

- T3 Classic with Interface Adapter
- T3 IP Classic
- T3 IP II Classic
- T3 IP Classic with Interface Adapter
- TH13
- TM13
- TS13
- T3 Compact
- T3 IP Comfort
- T3 IP II Comfort
- OS 13
- OS33



+

EHS Cable



APT-31*
PN: 37820-11

* APT-31 replaces APT-30

+

Plantronics Audio Solutions



Savi 700 Series
Wireless headset system manages PC, mobile and desk phone calls

CS500 Series
Wireless headsets manage desk phone calls

MDA200
Enables USB connectivity to the desk phone to manage both PC and desk phone calls

EHS Setup Use the EHS setup below to automatically answer a desk phone call by pressing a button on your Savi 700 Series or CS500 Series headset or MDA200.

Tenovis models: T3 Classic with Interface Adapter, T3 IP Classic, T3 IP II Classic T3 Classic with Interface Adapter, TH13, TM13, TS13, T3 Compact, T3 IP Comfort, T3 IP II Comfort, OS 13, OS33

Setup

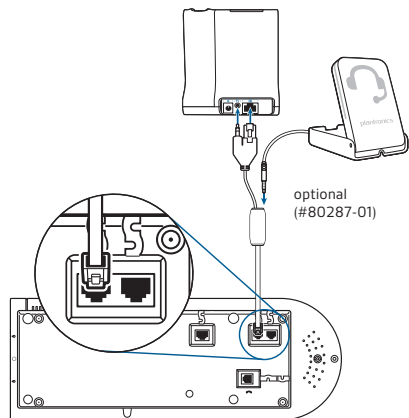

Configuration

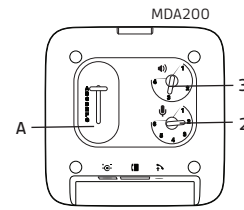
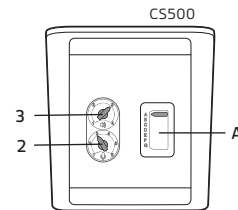
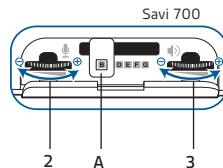

Electronic Hook Switch for T-Systems®

...T...Systems®



Desk Phone Models
F20, F30, F40, F50,
F630, F640, F660, F680

+

EHS Cable



APS-11*
PN: 37818-11

* APS-11 replaces APS-10

+

Plantronics Audio Solutions



Savi 700 Series
Wireless headset system manages PC, mobile and desk phone calls

CS500 Series
Wireless headsets manage desk phone calls

MDA200
Enables USB connectivity to the desk phone to manage both PC and desk phone calls

EHS Setup Use the EHS setup below to automatically answer a desk phone call by pressing a button on your Savi 700 Series or CS500 Series headset or MDA200.

T-Systems models: F20, F30, F40, F50

Setup

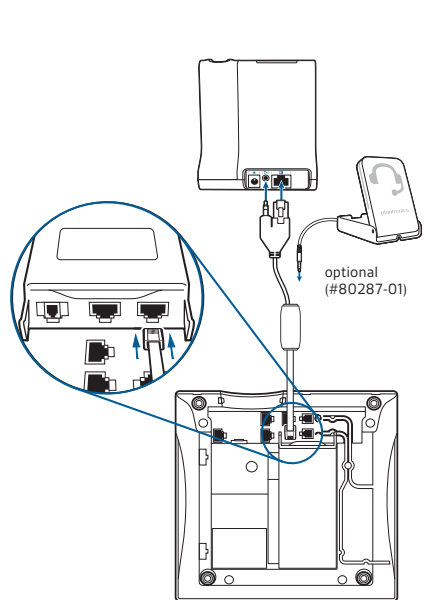

Configuration

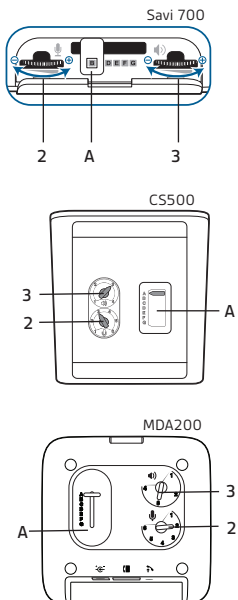

T-Systems models: F630, F640, F660, F680

Setup

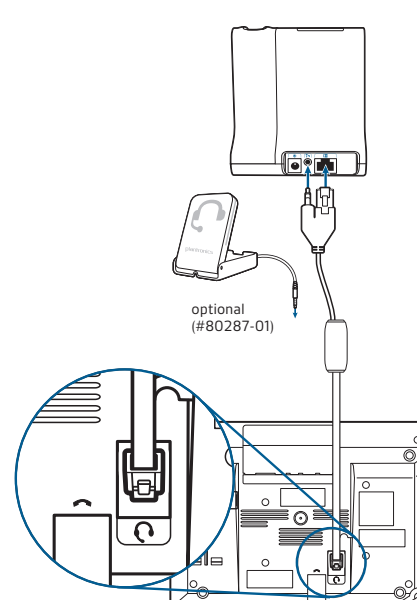

Configuration

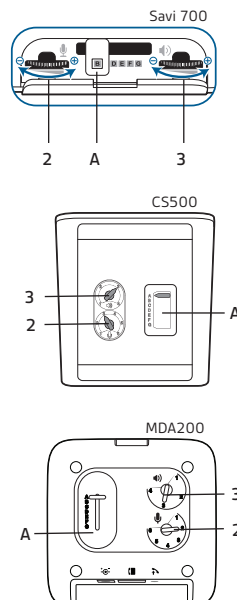

Electronic Hook Switch for T-Systems

...T...Systems®



Desk Phone Models
140 IP, 141, 150 IP, 151, 160 IP

+

EHS Cable



APA-23*
PN: 38908-11

*APA-23 replaces APA-20 and APA-22

+

Plantronics Audio Solutions



Savi 700 Series
Wireless headset system manages PC, mobile and desk phone calls



CS500 Series
Wireless headsets manage desk phone calls



MDA200
Enables USB connectivity to the desk phone to manage both PC and desk phone calls

EHS Setup Use the EHS setup below to automatically answer a desk phone call by pressing a button on your Savi 700 Series or CS500 Series headset or MDA200.

T-Systems models: IP Phones

Setup

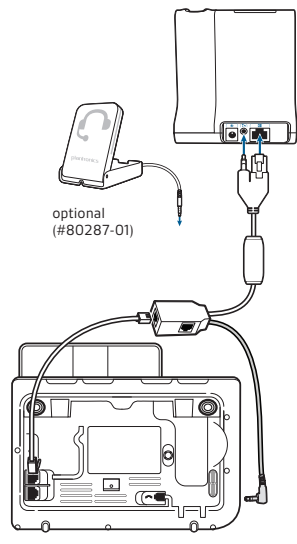

Configuration

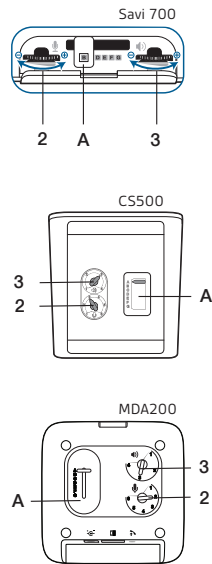

T-Systems models: 141, 151

Setup

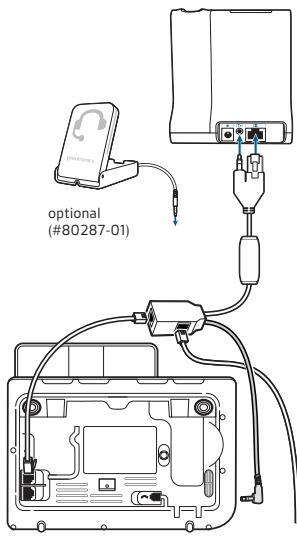

Configuration

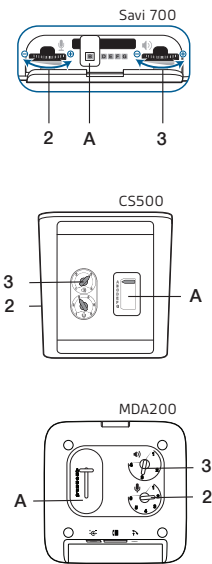

T-Systems models: My IC 8082

Setup

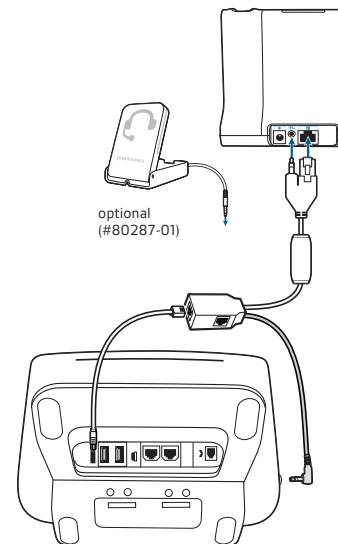

Configuration

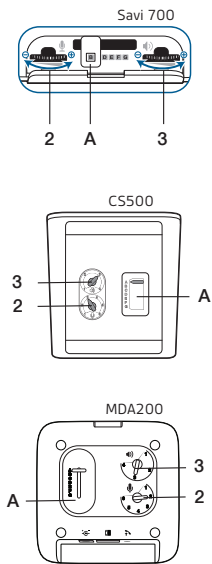

Electronic Hook Switch for Tiptel



tiptel

Desk Phone Models
 85 System (works with PABX Family Tiptel 3011/22 system/office)
 274
 275



EHS Cable



APS-11*
 PN: 37818-11

*APS-11 replaces APS-10



Plantronics Audio Solutions



Savi 700 Series
 Wireless headset system manages PC, mobile and desk phone calls

CS500 Series
 Wireless headsets manage desk phone calls

MDA200
 Enables USB connectivity to the desk phone to manage both PC and desk phone calls

EHS Setup Use the EHS setup below to automatically answer a desk phone call by pressing a button on your Savi 700 Series or CS500 Series headset or MDA200.

Tiptel models: 85 System, 274, 275

Setup

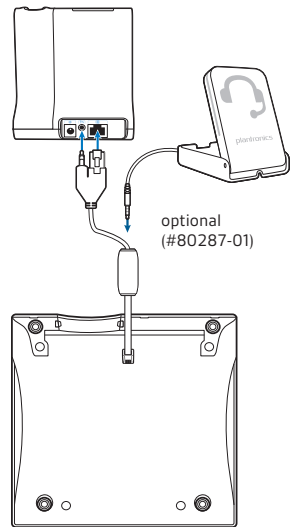

Configuration

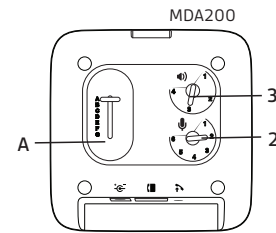
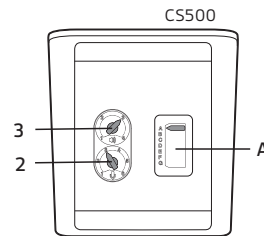
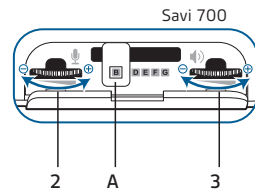

Electronic Hook Switch for Snom



snom
Desk Phone Models
320
360
370
820
870



EHS Cable



Order from SNOM
EHS Advance PN: 2362



Plantronics Audio Solutions



Savi 700 Series
Wireless headset system manages PC, mobile and desk phone calls

CS500 Series
Wireless headsets manage desk phone calls

MDA200
Enables USB connectivity to the desk phone to manage both PC and desk phone calls

EHS Setup Use the EHS setup below to automatically answer a desk phone call by pressing a button on your Savi 700 Series or CS500 Series headset or MDA200.

Snom models: 320, 360, 370, 820, 821, 870

Setup

Configuration

